



E.B. Horsman & Son

The Electrical Distributor of Choice!

*proud distributor
of*



IPEX

Visit our

You Tube Channel

www.youtube.com/user/ebhorsman

Shop Online



ebhorsman.com

WEATHERPROOF COVERS

Manufactured with stainless steel return-springs/clips and packaged with brass screws, Scepter weatherproof covers provide a positive seal, even in cold temperatures.

Description	Device Opening (in)	Part Number	Product Code
Single Gang Weatherproof Covers			
Plunger-style Switch Cover		VPT15/10	077630
Toggle Switch Cover		VSC15/10	077612
Grey Toggle Switch Cover		WTG15/10	077606
Grey Duplex Receptacle		WDR15/10	077993
White Duplex Receptacle		RWDR15/10	077786
Grey Ground Fault Receptacle		WGF15/10	077785
White Ground Fault Receptacle		RWGF15/10	077787
Single Receptacle Device 15 AMP	1.375	WTL15	077992
Single Receptacle Device 20 AMP	1.625	WTL20	077994
Single Receptacle Device 30 AMP	1.722	WTL30	077991
Single Receptacle Device 50 AMP	2.187	WTL50	077951
Grey Double Door Duplex Receptacle		WDRE15/10	077087
White Double Door Duplex Receptacle		RWDRE15/10	077408
Gasket for W Series Cover (except WDRE & RWDRE)		GASKW	077755
Gasket for WDRE & RWDRE Covers		GASKDD	072225

Gaskets are included with all weatherproof covers.



Double Gang Weatherproof Covers – OLD Style

Toggle Switch Cover	VSC20-2	077741
Combination Switch Cover & GFI Receptacle	VSRC20-2	077742
Combination Switch Cover & Duplex Receptacle	VSDR20-2	077752
Combination Switch Cover & Single Receptacle	VSRR20-2	077753
Double Door GFCI Cover	VSGG20-2	077096
Double Door Duplex Cover	VSDD20-2	077097
Gasket for Double Gang (except VSGG20-2 & VSDD20-2)	GASK20-2	077743
Gasket for VSGG20-2 and VSDD20-2 Double Gangs	GASKV20-2	072227

Gaskets are included with all weatherproof covers.

VSGG20-2 and VSDD20-2 are universal and will fit on most PVC and metal boxes.



Double Gang Weatherproof Covers – NEW Style *(only fits new style double gang boxes)*

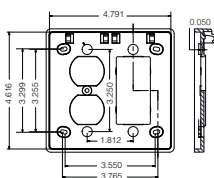

Toggle Switch Cover	VSCU20-2	077376
Combination Switch Cover & GFI Receptacle	VSRCU20-2	077357
Combination Switch Cover & Duplex Receptacle	VSDRU20-2	077356
Gasket	GASKFU20-2	172650

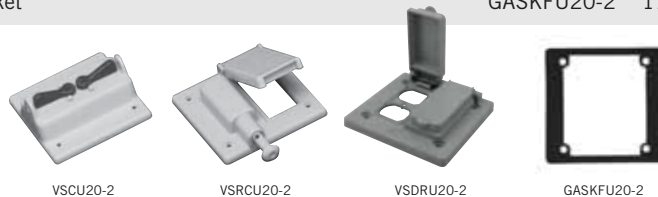

Lower Mainland Locations

Burnaby
3935 2nd Avenue
Burnaby, BC V5C 3W9
Tel: 604-292-4800

Langley
#101 - 20550 Duncan Way
Langley, BC V3A 7A3
Tel: 604-533-1275

Richmond
12360 Vickers Way
Richmond, BC V6V 1H9
Tel: 604-273-1981

Surrey
13055 80th Avenue
Surrey, BC V3W 3B1
Tel: 604-596-7111

Island Locations

Campbell River
1030 B - 9th Avenue
Campbell River, BC V9W 4C2
Tel: 250-287-9265

Courtenay
2615 Moray Place
Courtenay, BC V9N 8A9
Tel: 250-334-0338

Duncan
5286 Polkey Road
Duncan, BC V9L 6W3
Tel: 250-748-3377

Parksville
#105 - 425 E. Stanford Avenue
Parksville, BC V9P 2N4
Tel: 250-954-1797

Interior Locations

Cranbrook
Unit A #800 Industrial Road. #2
Cranbrook, BC V1C 4C9
Tel: 250-489-4591

Kamloops
B-983 Camosun Crescent
Kamloops, BC V2C 6G1
Tel: 250-374-3191

Penticton
401 Okanagan Avenue
Penticton, BC V2A 3K1
Tel: 250-492-4032

Vernon
5203 24th Street
Vernon, BC V1T 8X7
Tel: 250-545-2191

Williams Lake
527 S. MacKenzie Avenue
Williams Lake, BC V2G 1C8
Tel: 250-392-7795

Alberta Locations

Unit 9, 7223 68 Avenue,
Edmonton, Alberta T6B 3T6

Northern Locations

Dawson Creek
1101 97th Avenue
Dawson Creek, BC V1G 1N5
Tel: 250-782-4896

Fort Nelson
PO Box 3266 - 5016 48th Avenue
Fort Nelson, BC V0C 1R0
Tel: 250-233-8570

Kitimat
622 Commercial Avenue
Kitimat, BC V8C 2C5
Tel: 250-632-3774

Prince George
2255 S. Quinn Street
Prince George, BC V2N 2X4
Tel: 250-563-0575

Terrace
5000 Pohle Avenue
Terrace, BC V8G 4S8
Tel: 250-635-6379

Specialty Divisions

Process, Automation &
Controls Group
Tel: 778-545-9916

Projects Group
Tel: 604-596-7111

Data Communications Group
Tel: 778-545-9916

Lighting Specialist
Tel: 778-545-9916



Head Office
19295 25th Avenue
Surrey, BC V3Z 3X1
Tel: 778-545-9916
Fax: 778-545-3099
Toll Free: 1-888-467-7626

Visit our

You Tube Channel

www.youtube.com/user/ebhorsman

Shop Online



ebhorsman.com