

Raychem E104 E304 E307

THREE POLE CONTACTOR INSTALLATION INSTRUCTIONS

E104

100-A Three-pole Contactor for Nonhazardous locations

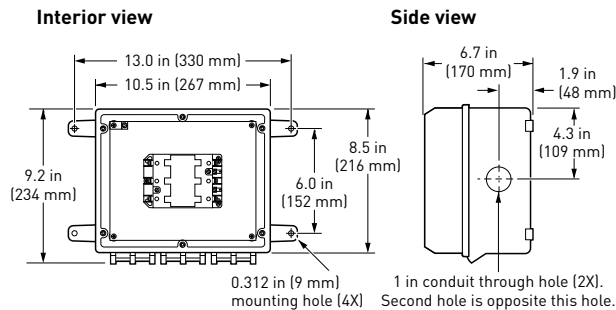

DESCRIPTION

The E104 is a three-pole 100 amp per pole contactor housed in a NEMA 4X enclosure.

SPECIFICATIONS

Enclosure	NEMA 4X	
Power Connection	Pressure lugs for 14-4 AWG wire	
Contactor Rating	100 A per pole, 600 Vac maximum, UL Recognized, CSA Certified	
Order with appropriate coil	Coil Rating	Catalog Number
	110-120 Vac	E104-100-120
	208-240 Vac	E104-100-208/240
	277 Vac	E104-100-277
	480 Vac	E104-100-480
	600 Vac	E104-100-600

E304

40-A Three-pole Contactor for Nonhazardous Locations

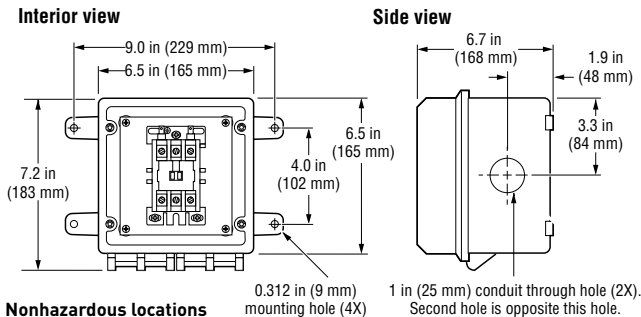

Nonhazardous locations



DESCRIPTION

The E304 is a three-pole 40 amp per pole contactor housed in a NEMA 4X enclosure.

SPECIFICATIONS

Enclosure	NEMA 4X	
Power Connection	Pressure lugs for 14-4 AWG wire	
Contactor Rating	40 A per pole, 600 Vac maximum, UL Recognized, CSA Certified	
Order with appropriate coil	Coil Rating	Catalog Number
	110-120 Vac	E304-40-120
	208-240 Vac	E304-40-208/240
	277 Vac	E304-40-277
	480 Vac	E304-40-480
	600 Vac	E304-40-600

E307

40-A Three-pole Contactor for Hazardous Locations

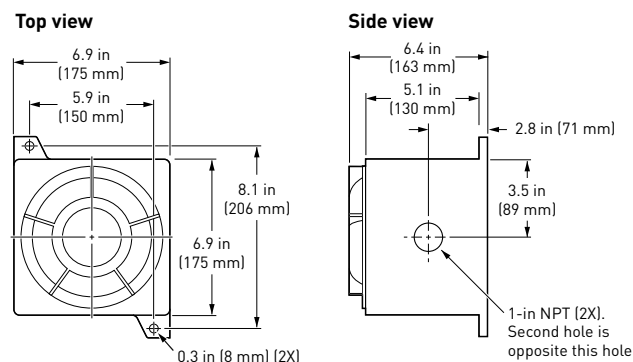

DESCRIPTION

The E307 is a three-pole 40 amp per pole contactor housed in a NEMA 4, 7, 9 aluminum enclosure that is approved for hazardous locations.

SPECIFICATIONS

Enclosure	NEMA 4,7,9 FM Approved for Class I, Div. 1 & 2, Groups B, C, D; Class II, Div. 1 & 2, Groups E, F, G; Class III	
Power Connection	Pressure lugs for 14-4 AWG wire	
Contactor Rating	40 A per pole, 600 Vac maximum, UL Recognized, CSA Certified	
Order with appropriate coil	Coil Rating	Catalog Number
	110-120 Vac	E307-40-120
	208-240 Vac	E307-40-208/240
	277 Vac	E307-40-277
	480 Vac	E307-40-480
	600 Vac	E307-40-600

Installing the Contactor

1. Verify that the contactor is suitable for the area where it is to be installed.
2. Check the line voltage and the heat-tracing load to ensure that the contactor ratings are not exceeded.
3. Mount the enclosure in a position that prevents condensation from draining into the enclosure from the connecting conduit (see diagram at right).

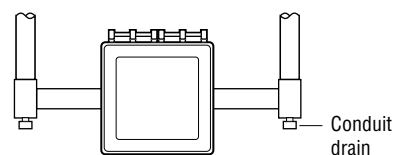

Wiring

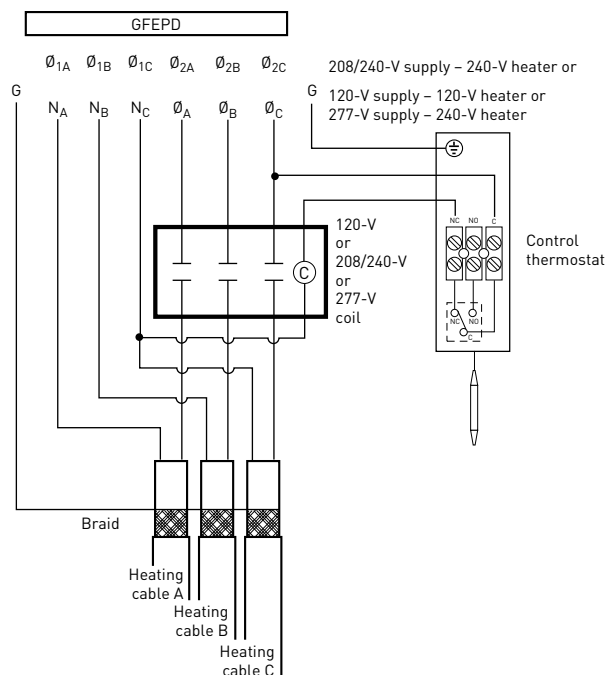

Figure 1.

Contactor control for switching heat-tracing loads greater than 22 A or switching multiple heat-tracing circuits.

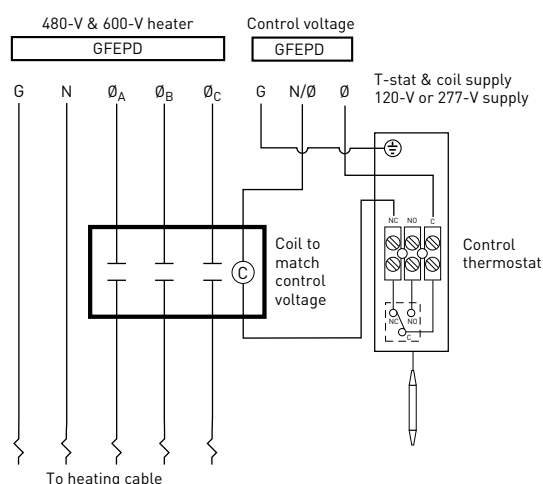

Figure 2.

Contactor control for switching heating cable On/Off.



WWW.PENTAIRTHERMAL.COM

NORTH AMERICA

Tel: +1.800.545.6258
Fax: +1.800.527.5703
Tel: +1.650.216.1526
Fax: +1.650.474.7711
thermal.info@pentair.com

EUROPE, MIDDLE EAST, AFRICA

Tel: +32.16.213.511
Fax: +32.16.213.603
thermal.info@pentair.com

ASIA PACIFIC

Tel: +86.21.2412.1688
Fax: +86.21.5426.2937
cn.thermal.info@pentair.com

LATIN AMERICA

Tel: +1.713.868.4800
Fax: +1.713.868.2333
thermal.info@pentair.com

Pentair is owned by Pentair or its global affiliates. All other trademarks are the property of their respective owners. Pentair reserves the right to change specifications without prior notice.